

# Tanking Kit & Tanking Paste

Waterproofing Kit for areas exposed to wet/damp conditions

- Protects water sensitive substrates from exposure to water
- Seals and stabilises surfaces prior to applying tiles
- Single coat system, no priming required
- Fast drying, apply tiles after 3 hours
- Ready to use, easy to apply
- Ideal for wetrooms, showers, steamrooms and bathrooms
- Can be used internally and externally

Single Coat System

No Priming Required

Tile After 3 Hours

Uses Co-polymer Technology



# TILEMASTER TANKING KIT & TANKING PASTE

## Waterproofing Kit for areas exposed to wet/damp conditions

### DESCRIPTION:

Tilemaster Tanking Paste is a single coat, fast drying sealant system based on co-polymer technology. It is designed to produce a barrier to moisture that is flexible enough to accommodate slight movement and/or vibration which may be expected under normal conditions of use in and around well constructed, structurally stable floors, walls and shower cubicles. The system seals, stabilises and prepares substrates ready for the installation of ceramic, porcelain and natural stone tiles.

The Tilemaster Tanking Kit comprises of a pre-mixed, easy to use waterproofing paste that is reinforced with fleece tape and preformed corner tape. All contents of the Tilemaster Tanking Kit can be purchased individually.

Tilemaster Tanking Paste has been designed to be applied as a single coat application at approximately 0.5mm in thickness. Applying Tilemaster Tanking Paste at 0.5mm thickness provides a fully tanked and waterproof membrane for tiling onto.

Tilemaster Tanking Paste is fast drying and therefore ceramic, porcelain and natural stone tiles can be applied after 3 hours in ideal conditions.

**N.B Tilemaster Tanking Paste is not suitable to be used to control rising damp and is not suitable for use as a damp proof membrane.**

### PREPARATION:

Surfaces must be sound and free from dust, dirt, grease, oil and any other contaminants. Any laitance or surface treatments must be removed before application. Concrete, sand/cement screeds, anhydrite screeds and power floated concrete must be fully cured, with any dust from the surface removed by vacuum.

The temperature of the surface must be above 5°C when Tilemaster Tanking Paste is applied. Underfloor heating systems must be switched off 48 hours before application. Timber and over boarded substrates must be rigidly braced and sufficiently constructed to take domestic loading without movement.

If there any gaps between wall and floor joints/junctions, tile backer boards or other surfaces that are greater than 2mm, these should be filled with an appropriate filler such as silicone sealant. Wide gaps should be filled with cement based, flexible tile adhesive. Allow all filled joints and junctions to dry before applying Tilemaster Tanking Paste.

**NB. Solvent based sealants must be used for filling gaps**

### APPLICATION AREAS/ENVIRONMENTS:

- ✓ Domestic and Commercial Showers
- ✓ Bathrooms
- ✓ Wetrooms
- ✓ Steamrooms
- ✓ Laundry/Utility Rooms
- ✓ Areas Subject to Prolonged Wet Conditions

### SUBSTRATES:

- ✓ Sand/Cement Screed
- ✓ Concrete
- ✓ Plywood Overlay
- ✓ Electric Underfloor Heating
- ✓ Water/Wet System Underfloor Heating
- ✓ Tile Backer Boards
- ✓ Existing Ceramic, Porcelain and Natural Stone Tiles
- ✓ Anhydrite Screeds
- ✓ Plaster
- ✓ Plasterboard
- ✓ Fibre Cement Sheet
- ✓ Cement/Sand Render
- ✓ Concrete Brick/Block
- ✓ T & G Floorboards

#### Tilemaster Adhesives Ltd.

Unit 4, Tomlinson Point, Tomlinson Road, Leyland, Lancashire, PR25 2DY.

Telephone: **01772 456831**

email: [info@tilemasteradhesives.co.uk](mailto:info@tilemasteradhesives.co.uk)



[www.tilemasteradhesives.co.uk](http://www.tilemasteradhesives.co.uk)

# TILEMASTER TANKING KIT & TANKING PASTE

## Waterproofing Kit for areas exposed to wet/damp conditions

### APPLICATION:

**STAGE 1** Using a suitable brush or roller, apply a thin coat (approx. 0.5mm) of Tilemaster Tanking Paste to all joins/joints, corners, cracks and junctions between walls and floors. The Tilemaster Tanking Paste should be applied slightly wider than the reinforcing tape supplied. We recommend working in small areas until you have become accustomed to the product.

**STAGE 2** The reinforcing tape and corners are designed to be bedded into the Tilemaster Tanking Paste, wetting out the tape and therefore creating a highly flexible, reinforced waterproof membrane. Whilst the Tilemaster Tanking Paste is still wet, apply the preformed corners and bed them firmly into place ensuring that no air pockets remain trapped and that the corners are flush with the corners/junctions.

**STAGE 3** Once the corners have been sealed, the straight runs of reinforcing tape can be applied. Cut to measure the joint reinforcing tape to cover allowing a minimum of 50mm for any overlap. Apply additional Tilemaster Tanking Paste to any previously fitted corners or tape to ensure the adhesion of tape to tape. Apply the reinforcing tape to all vertical and horizontal joins, joints and junctions of the surface to be sealed. Place the joint reinforcing tape onto the applied Tilemaster Tanking Paste and smooth down with a flat trowel or float, again ensuring that no air pockets remain. Repeat this operation ensuring that all joins, joints and junctions are reinforced.

**STAGE 4** One coat of Tilemaster Tanking Paste should now be applied by brush or roller to all surfaces that require Tanking. The Tilemaster Tanking Paste should be applied to a thickness of approximately 0.5mm, ensuring that all areas are covered.

Please note, applying excess Tilemaster Tanking Paste will result in extended drying times and the possibility of the Tilemaster Tanking Paste peeling.

**STAGE 5** Once the Tilemaster Tanking Paste has been applied, tiling can commence after 3 hours providing the Tilemaster Tanking Paste is touch dry.

The drying/curing time will depend on the porosity of the substrate, the thickness of the Tilemaster Tanking Paste applied and the ambient conditions/temperatures. Please note – in poor conditions, the drying time could be extended beyond 3 hours.

**STAGE 6** The Tilemaster Tanking Paste does not need to be primed prior to applying tile adhesive. Ensure that the previously applied Tilemaster Tanking Paste is free from dust, dirt and contaminants. A cement based tile adhesive from the Tilemaster range should be used for fixing tiles to the Tilemaster Tanking System.

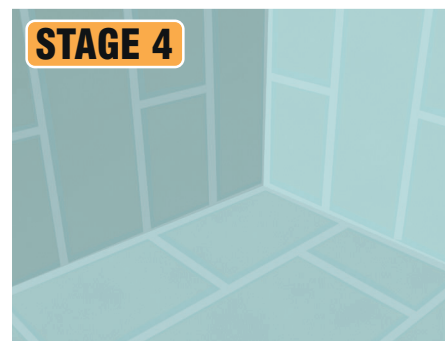
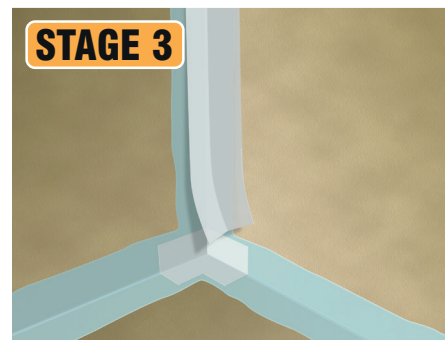
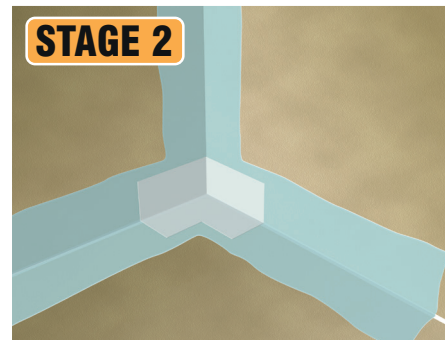
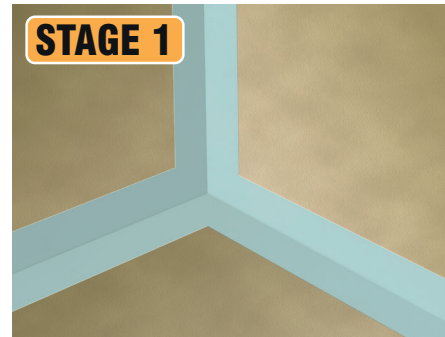

### Tilemaster Adhesives Ltd.

Unit 4, Tomlinson Point, Tomlinson Road, Leyland, Lancashire, PR25 2DY.

Telephone: **01772 456831**

email: [info@tilemasteradhesives.co.uk](mailto:info@tilemasteradhesives.co.uk)



[www.tilemasteradhesives.co.uk](http://www.tilemasteradhesives.co.uk)

# TILEMASTER TANKING KIT & TANKING PASTE

## Waterproofing Kit for areas exposed to wet/damp conditions

Pack Size	3.5kg
Pack Contents	2.5kg Tanking Paste, 10 metre roll of reinforcing tape, 2 internal corners and latex gloves
Coverage	2.5kg Tanking Paste covers approximately 7m <sup>2</sup> when applying at 0.5mm thickness.
Application Temperature	Between 5°C and 35°C
Drying Time Before Tiling	<p>In ideal conditions tiling can commence 3 hours after Tilemaster Tanking Paste has been applied, providing the coat is touch dry.</p> <p><b>Please note</b> - In warm conditions, the drying time may be decreased, likewise, in cold conditions the drying time may be decreased.</p> <p>The drying/curing time of Tilemaster Tanking Paste will depend on the porosity of the substrate, thickness of Tilemaster Tanking Paste applied and the ambient conditions/temperatures.</p>
Contact with Water	During the drying process of Tilemaster Tanking Paste, the coated areas must be protected from moisture and contact with water.
Storage	Store unopened, clear of the ground and in cool, dry conditions.
Shelf Life	Stored correctly this product has a shelf life of 12 months.
Paste Colour	Blue
Note	All work must be carried out in accordance with British Standard Code of Practice for floor and wall tiling BS5385

### HEALTH AND SAFETY

The components of Tilemaster Tanking Kit and Tilemaster Tanking Paste are not classified as hazardous. However, it is recommended that elementary health precautions be followed, including: wear protective gloves and glasses, ventilate working areas, if there is accidental contact with skin or eyes wash thoroughly with water. Do not allow the paste to dry on the skin. Keep out of reach of children.

For further information refer to the Material Safety Data Sheet.

The information contained on this spec sheet is given voluntarily and in good faith. It is to the best of our knowledge true and accurate; however, it may contain information which is inappropriate under certain conditions of use. The company cannot accept responsibility for any loss or damage due to inappropriate use or the possibility of variations of working conditions and of workmanship outside our control.

#### Tilemaster Adhesives Ltd.

Unit 4, Tomlinson Point, Tomlinson Road, Leyland, Lancashire, PR25 2DY.

Telephone: **01772 456831**

email: [info@tilemasteradhesives.co.uk](mailto:info@tilemasteradhesives.co.uk)



[www.tilemasteradhesives.co.uk](http://www.tilemasteradhesives.co.uk)